

Spare Parts

■ ODI

CKG007

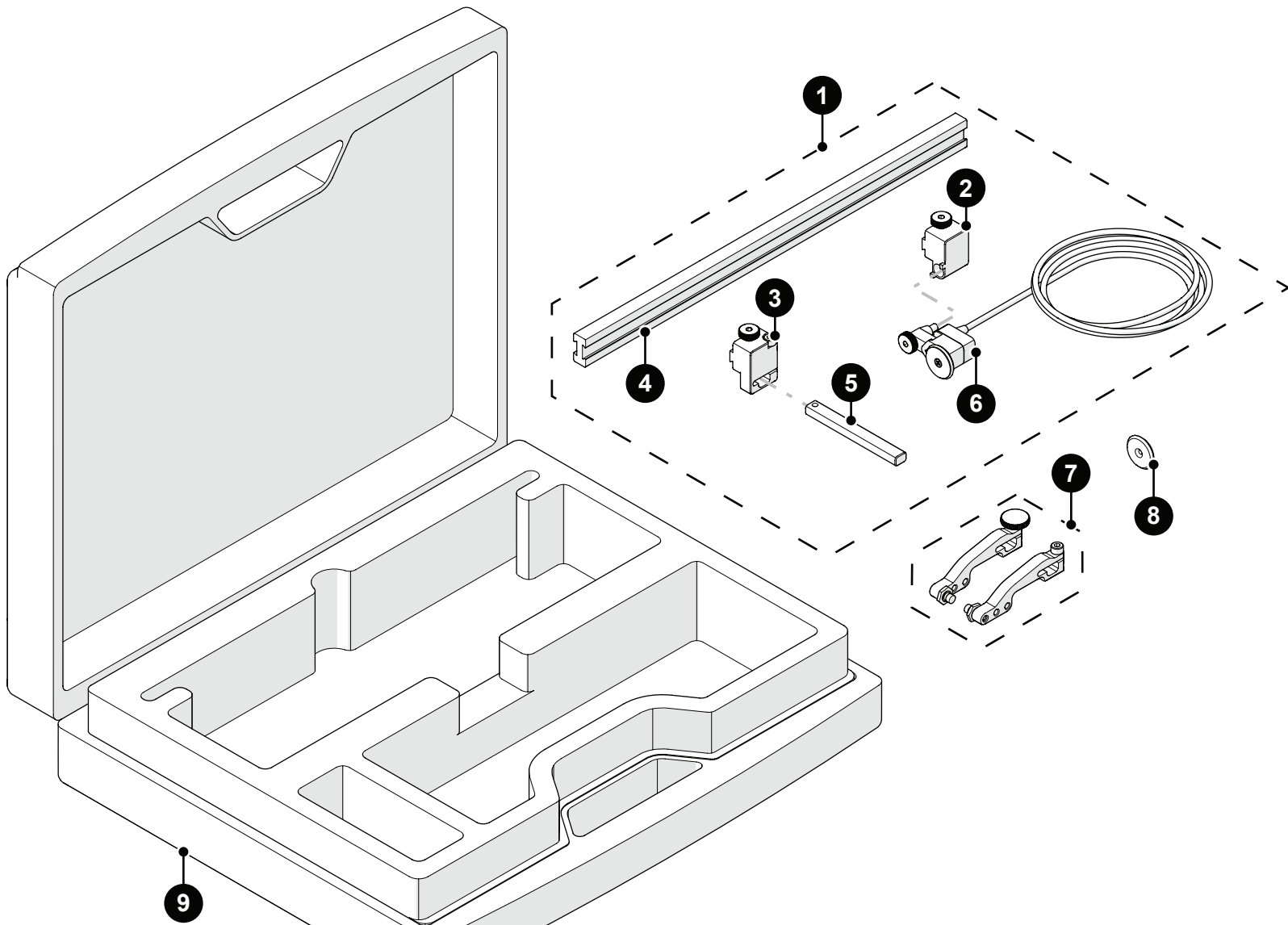

BOM ID	Part #	Description
1	CKS010-X-05	Base ODI-II (see <i>Encoder Connector Types</i>)
2	CKS015	Encoder Clamping Mount
3	CKS014	Yoke Clamping Mount
4	CK0047-X	Dovetail Slide Frame Bar (30 mm, various lengths available)
5	CK0018	Clamp Arm (70 mm, various lengths available)
6	CKS011-X-05	Encoder Assembly (see <i>Encoder Connector Types</i>)
7	PHG0XX-BXX	Probe Holder Arm Set (various styles available)
8	CK0064	Heat treated stainless steel encoder wheel
9	CKA010	ODI-II Case

For information on various options, contact infor@jireh.com or visit jireh.com

Spare Parts



Pivot Button Style

	Pivot Hole Size	Wedge Type			Pivot Hole Size	Wedge Type	
01	8.0 mm (0.315 in)	Olympus PA		02	5.0 mm (0.197 in)	Olympus TOFD	
03	2.7 mm (0.106 in)	Sonatest DAAH PA		04	9.5 mm (0.375 in)	-	
06	3.0 mm (0.118 in)	-		07	2.3 mm (0.090 in)	-	
08	Conical Head	-		09	5 mm (0.197 in) Internal	Zetec PA/TOFD	

Encoder Connector Type

Connector Type	Company/Instrument	Connector Type	Company/Instrument
B	Olympus OmniScan MX Zetec Topaz	G	Sonotron Isonic 25xx
C	Olympus Focus LT Zetec Z-Scan Eddyfi Ectane 2	U	Sonatest Veo / Prisma
E	Olympus OmniScan SX/MX2/X3 M2M MANTIS/GEKKO LEMO	V	Pragma PAUT
F	TD (<i>Technology Design</i>)	AD	Sonatest Veo / Prisma - Single Axis

NOTE: Additional encoder connector types available. Contact JIREH for more information.

Arm Style

Arm Style	Part #		Arm Style	Part #	
A Standard, Flat	PH0090		B Short, Flat	PH0089	
C Long, Flat	PH0099		D Standard, Drop	PH0093	
E Short, Drop	PH0092		F Long, Drop	PH0094	
G Standard, Extra-Drop	PH0096		H Short, Extra-Drop	PH0095	
I Extra-Short, Flat	PH0159		J Extra-Short, Drop	PH0161	