

5. When motorized couplant pump use is complete, close the flow control valve (rotate clockwise) and turn the power switch **OFF**.
6. Depressurize the system before transporting.
 - a. Ensure the pump is unplugged from a power source and the power switch is **OFF**.
 - b. Disconnect the irrigation kit from the outlet.
 - c. Disconnect the inlet hose (Fig. 5-1) and insert the inlet hose into the outlet (Fig. 5-2).
 - d. Open the flow control valve until all the pressure is released from the system.

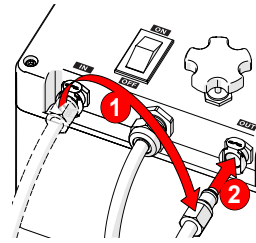

Fig. 5 - Pump Assembly

Chapter 5

MAINTENANCE AND SUPPORT

1. The motorized couplant pump should be serviced by qualified personnel only. Always disconnect the power source before servicing.
2. For technical support, contact JIREH.

Chapter 6

TROUBLESHOOTING

Problem	Possible Cause	Solution
The pump does not discharge fluid	The flow control valve is not opened, the power switch is not turned on, the power source is disconnected, inlet/outlet connections are not attached, inlet filter is not placed in a fluid.	Ensure the flow control valve is rotated counter-clockwise, the power switch is turned on, the power cord is plugged into a live source, inlet/outlet fittings are fully inserted, inlet filter is submerged in the fluid reservoir.
Pump flow inconsistent	Hose kinked, hose split, inlet filter plugged.	Ensure hoses are not split or kinked, and remove/replace the inlet filter.

Chapter 7

SPARE PARTS

BOM ID	Part #	Description
1	CMS038	Inlet Filter
2	LA021	Inlet Hose
3	LA081	Quick Connect Fitting: 7/16 in
4	CMS037	Motorized Pump Inlet Tube

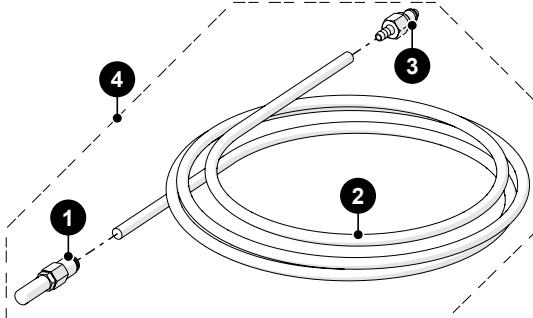

Fig. 6 - Inlet hose spare parts



Jireh Industries Ltd.

53158 Range Road 224
Ardrossan, Alberta
Canada
T8E 2K4

780.922.4534
jireh.com

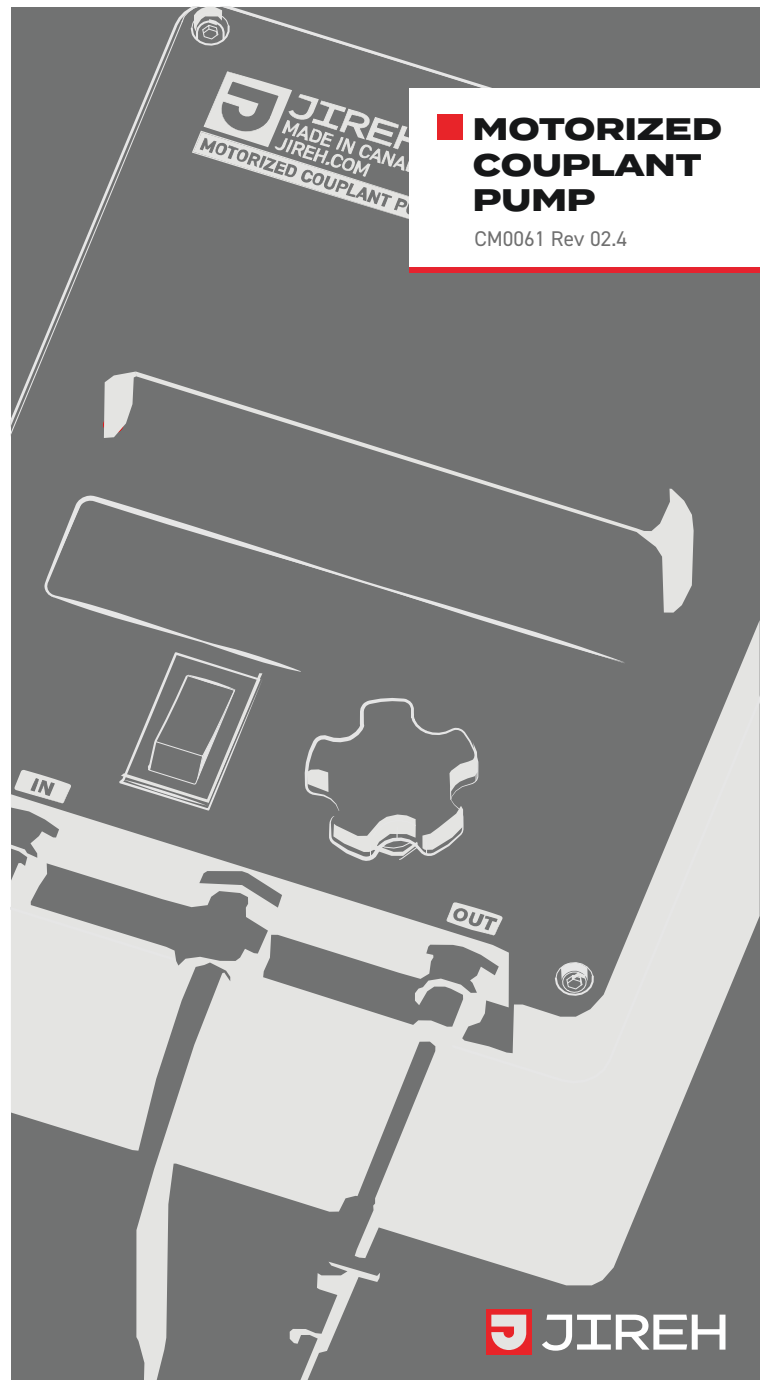

JIREH

SAFETY WARNINGS / PRECAUTIONS

KEEP THIS MANUAL – DO NOT LOSE

THIS MANUAL IS PART OF THE **MOTORIZED COUPLANT PUMP** AND MUST BE RETAINED FOR THE LIFE OF THE PRODUCT. PASS ON TO SUBSEQUENT OWNERS. Ensure any amendments are incorporated with this document.



CAUTION! The **MOTORIZED COUPLANT PUMP** is designed for a specific use. Using the **MOTORIZED COUPLANT PUMP** outside of its intended use could cause damage to the product. Read and understand this manual before using.



CAUTION!

- Do not freeze.
- Use proper PPE (*personal protective equipment, i.e. gloves and glasses*).
- Do not connect input to pressurized fluid source.
- Do not pump fluids hotter than 70° C (158° F).



WARNING!

- Use with GFCI (*ground fault circuit interrupter*) power source.
- Do not use in an explosive environment.
- Service by qualified personnel only.
- Do not use in a wet environment.
- Do not use with flammable liquid.



WARNING! DO NOT DISASSEMBLE. No user-serviceable parts. Disassembling any of the components in this product, beyond the instructions in this user manual, could void the regulatory certifications and/ or effect the safety of the product.



The WEEE symbol indicates that the product must not be disposed of as unsorted municipal waste, but should be collected separately.

SPECIFICATIONS

2.1. Intended Use

The motorized couplant pump aims to pump couplant fluid (non-toxic and Non-flammable) from a reservoir to a scanner for ultrasonic inspection.

2.2. Specifications

Power Input:	100-277 VAC, 50/60 Hz, 1.5 Amps
Output:	414 kPa (60 psi), 3.4 L/min (0.89 GPM) maximum.
Maximum Fluid Viscosity:	30 cSt
Part Number:	CMA015

2.3. Operating Environment

The motorized couplant pump is designed for use in an industrial environment that is between -20° C (-4°F) and 50° C (122°F).

The motorized couplant pump is designed for use in a dry, non-explosive environment.

PREPARATION FOR USE

3.1. Motorized Couplant Pump Component Identification

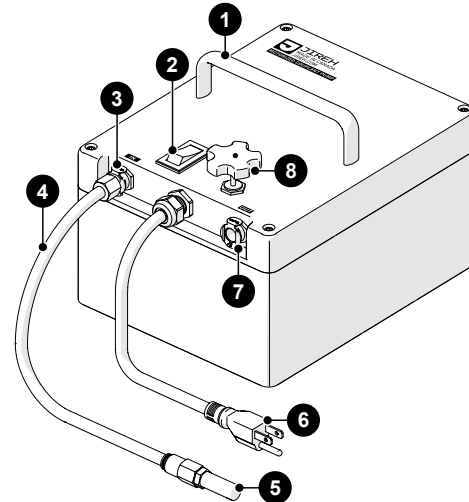

Fig. 1 - Pump Assembly

- | | |
|---|--------------------|
| 1 | Handle |
| 2 | Power Switch |
| 3 | Inlet |
| 4 | Inlet Hose |
| 5 | Inlet Filter |
| 6 | Power Chord |
| 7 | Outlet |
| 8 | Flow Control Valve |

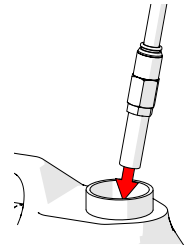

Fig. 2 - Inlet filter in couplant

3.2. Pump Setup

- Ensure the power switch is **OFF** (Fig. 1-2).
- Place the inlet filter (Fig. 1-5) into a reservoir of non-toxic, non-flammable couplant (Fig. 2). Ensure the opposite end of the inlet hose is connected to the motorized pump's inlet connection (Fig. 1-3).
- Connect the irrigation kit (sold separately) to the outlet (Fig. 3).
- Plug the power cord into a GFCI (*ground fault circuit interrupter*) protected power source.

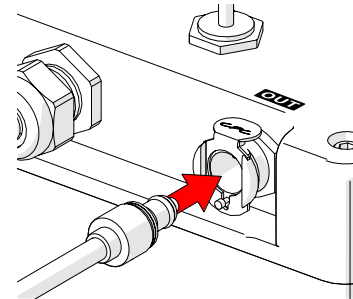

Fig. 3 - Connect irrigation kit to outlet

OPERATION

- Ensure the flow control valve (Fig. 1-8) is rotated clockwise, preventing unwanted couplant discharge upon unit activation.
- Turn the power switch to **ON** (Fig. 1-2).
- Open the flow control valve (*rotate counter-clockwise*) until the desired flow is achieved (Fig. 4).
- Close the flow control valve (*rotate clockwise*) to stop the fluid flow.

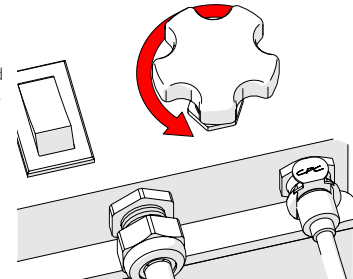

Fig. 4 - Control couplant with flow control valve