

TROUBLESHOOTING

Problem	Possible Cause	Solution
Pump difficult to operate or does not pressurize tank.	Plunger seal damaged or not lubricated.	Apply grease or petroleum jelly around the outside of the plunger seal.
Irrigation hose leaks at connector.	Connector or irrigation hose fitting is loose or damaged.	Ensure the connector is sealed tightly (<i>Only tighten by hand</i>). Remove damaged section of hose and reassemble
Leak at tank opening.	Pump not sealed tightly onto tank.	Apply grease or petroleum jelly to pump gasket/threads and tightly screw in pump to tank.
	Residue build-up or dirt around pump/tank gasket.	Thoroughly clean pump gasket/threads and surrounding area. Apply grease or petroleum jelly to pump gasket/threads.
	Damaged gasket.	Replace pump.

SPARE PARTS

BOM ID	Part #	Description
1	FA010	1 Litre (0.26 Gal.) Replacement Tank
2	CMS024	1 Litre (0.26 Gal.) Replacement Pump
3	CMS039	7.9 Litre (2.1 Gal.) Replacement Valve

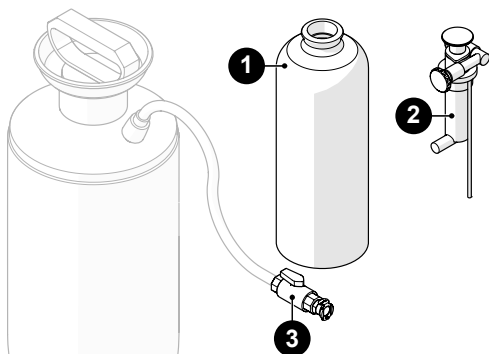

Jireh Industries Ltd.

53158 Range Road 224
Ardrossan, Alberta
Canada
T8E 2K4

780.922.4534

jireh.com

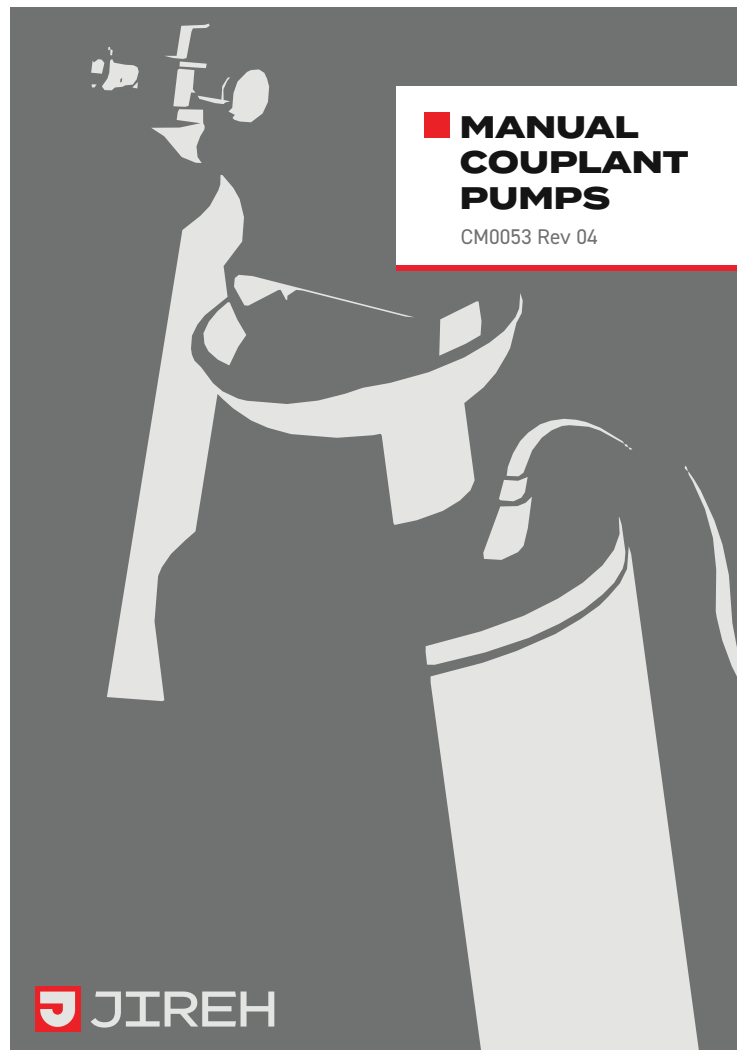

WARNING! Improper use or failure to follow instructions can result in explosive failure causing serious eye or other injury. For safe use of this product you must read and follow all instructions. Do not leave a pressurized sprayer in the hot sun. Heat can cause pressure build-up resulting in possible explosion. Do not store or leave solution in tank after use. Always wear goggles when spraying. Never use any tool to remove pump if there is pressure in sprayer. Never stand with face or body over top of tank when pumping or loosening pump to prevent ejecting pump assembly and/or solution from striking and injuring you. Never pressurize sprayer by any means other than the original pump. Do not attempt to modify this sprayer. Replace parts only with manufacturer's original parts. Never spray flammable, caustic, acidic, chlorine, bleach or other corrosive solutions or heat, pressure, or gas producing chemicals.

PRODUCT SPECIFICATIONS

1.1. Manual Couplant Pump

This section outlines the product specifications of the base system.

1.1.1. Intended Use

The manual couplant pumps are manually operated units used to pump couplant fluid. The manual couplant pumps are compatible with various JIREH irrigation kits and any standard JIREH scanner.

1.1.1.1. User

The manual couplant pump is intended to be used by persons who have read and understand this user manual.

1.1.1.2. Operating Environment

Category	Parameter	Specification
Environment	Minimum ambient temperature	-20°C (-4°F)
	Maximum ambient temperature	30°C (86°F)

1.1.2. Performance Specifications

Part #	Fluid Capacity	Irrigation Kit Comparability
CMA012	1 litre (0.26 gallon)	CMG008
CMA014	7.9 litre (2.1 gallon)	CMG007 & CMG009

PREPARATION FOR USE

2.1. Component Identification

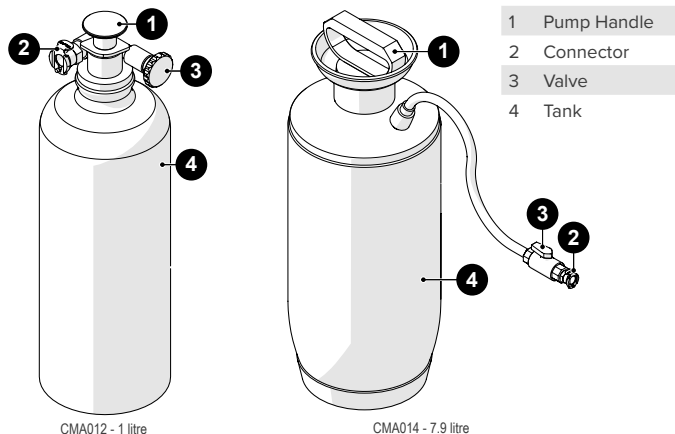

2.2. Pump Setup

1. Rotate the tank/pump counterclockwise to remove the pump.
2. Fill tank to the required level with the appropriate couplant fluid, do not overfill. Leave at least tank 10% empty for compressed air. (For best results, mix the couplant in a separate container and strain through a cloth or sieve while pouring into tank.)
3. Insert pump into the opening of the tank. Turn tank clockwise until pump is sealed tightly to tank.

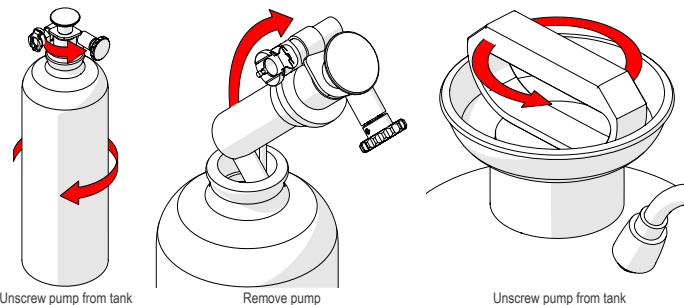

OPERATION

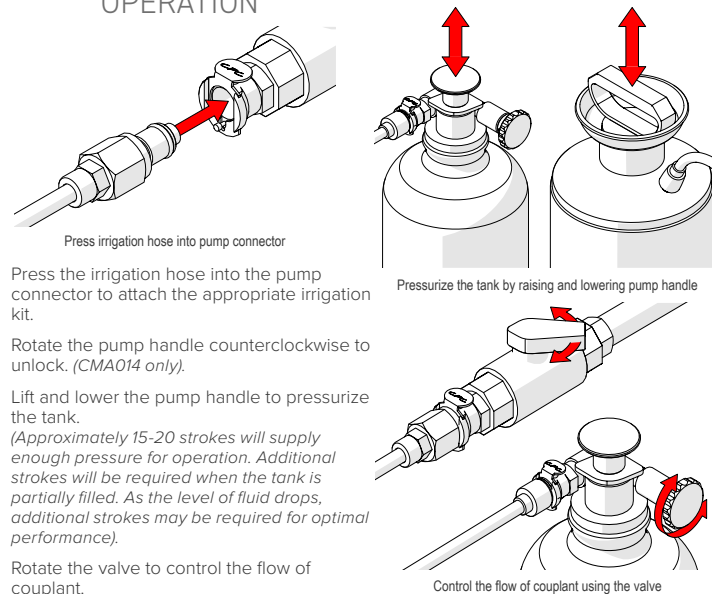

1. Press the irrigation hose into the pump connector to attach the appropriate irrigation kit.
2. Rotate the pump handle counterclockwise to unlock. (CMA014 only).
3. Lift and lower the pump handle to pressurize the tank. (Approximately 15-20 strokes will supply enough pressure for operation. Additional strokes will be required when the tank is partially filled. As the level of fluid drops, additional strokes may be required for optimal performance).
4. Rotate the valve to control the flow of couplant.

MAINTENANCE

1. Depressurize the tank when task is complete. Turn the tank upside down and open the valve to release the air pressure. (The connector contains an auto-off when the fitting is not connected. To depressurize the tank, a fitting must be connected to the connector).
2. Empty any remaining solution into a proper storage or disposal container. (Do not store couplant in the tank which can dry and clog the system).
3. Clean pump after each use to prolong the life of the equipment. (Rinse thoroughly with water. Ensure the hose and valve are flushed).
4. To store, hang the tank upside down with the pump removed.
5. Frequently check for worn or damaged parts.