

# USER MANUAL

## **KEEP THIS MANUAL – DO NOT LOSE**

THIS MANUAL IS PART OF THE MOTIX SYSTEM AND MUST BE RETAINED FOR THE LIFE OF THE PRODUCT. PASS ON TO SUBSEQUENT OWNERS.

Ensure any amendments are incorporated with this document.

## **1** INSTALLING ON CARRIAGE

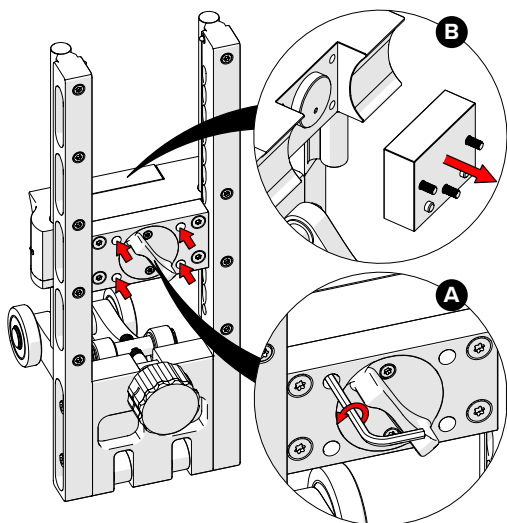

Fig. 1 - Disconnect the adapter block

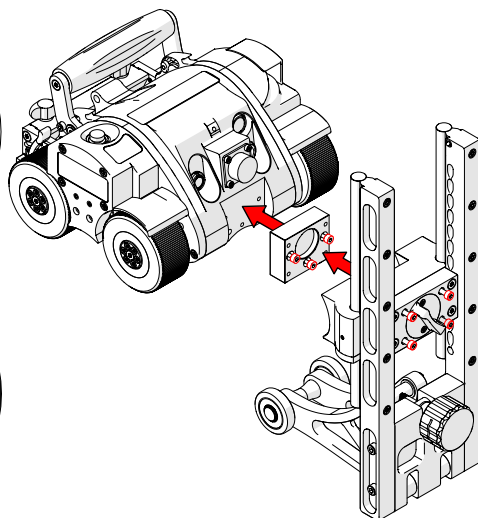

Fig. 2 - Attach adapter block and main assembly to the crawler

1. Utilize a 3 mm hex key to unscrew the four adapter block screws (*Fig. 1-A*).
2. Detach the adapter block from the main assembly (*Fig. 2-B*).
3. Bolt the three adapter block screws to attach the adapter block to the crawler (*Fig. 2*).
4. Bolt the four screws of the main assembly to the adapter block (*Fig. 2*).

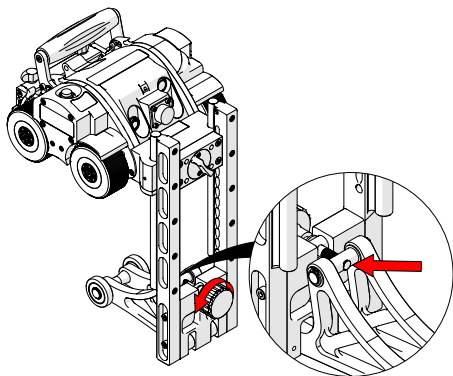

Fig. 3 - Adjust red knob to align threads with pin

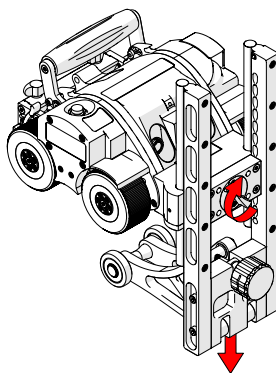

Fig. 4 - Twist to lower base

1. Rotate the fine adjustment knob counterclockwise until the threads are aligned flush with the pin (Fig. 3).
2. When required, twist the vertical release knob to lower the base, creating extra clearance for fitting onto the pipe (Fig. 4).

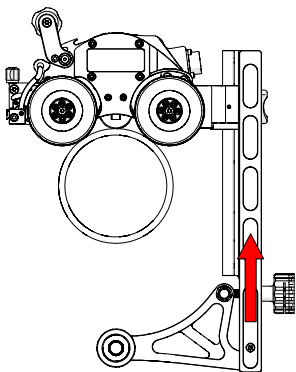

Fig. 5 - Press base to pipe

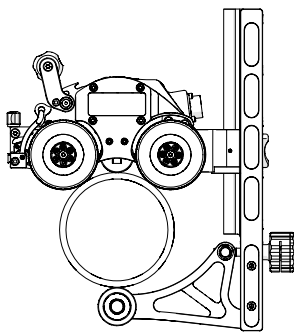

Fig. 6 - Base contacts pipe

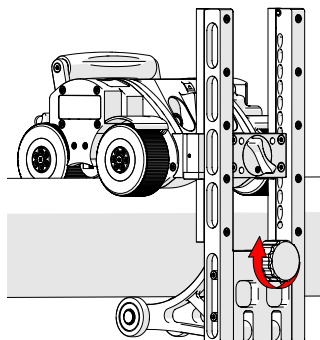

Fig. 7 - Twist to tighten on pipe

3. Press the base up (Fig. 5) against the pipe until it stops moving (Fig. 6).
4. Tighten the fine adjustment knob to secure the crawler onto the pipe. Make sure to tighten the system sufficiently to ensure the necessary traction is achieved. (Fig. 7).

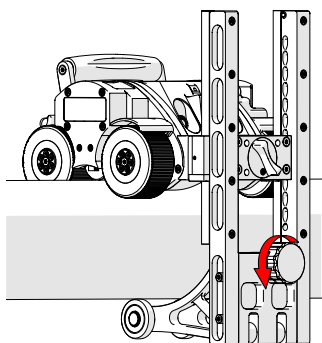

Fig. 8 - Loosen knob

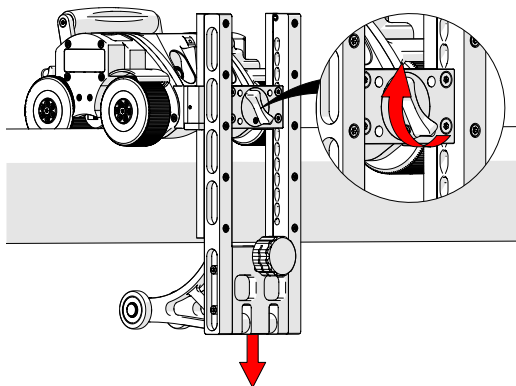

Fig. 9 - Adjust base to remove crawler

1. Loosen the fine adjustment knob until the end of the threads are flush with the pin, or until there is adequate clearance to remove the crawler from the pipe (*Fig. 8*).
2. If necessary, rotate the vertical release knob to allow the base to slide down, providing more clearance to remove the crawler from the pipe (*Fig. 9*).

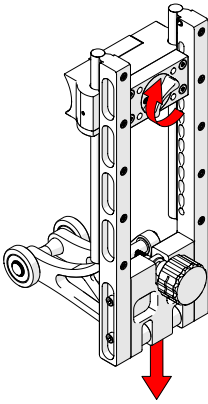

Fig. 10 - Move base to lowest position

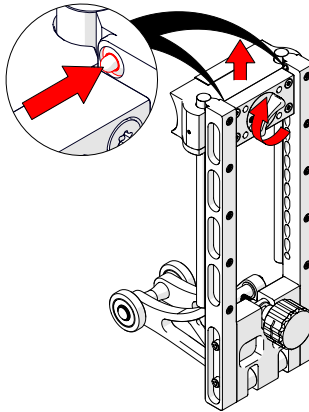

Fig. 11 - Press spring pins and remove

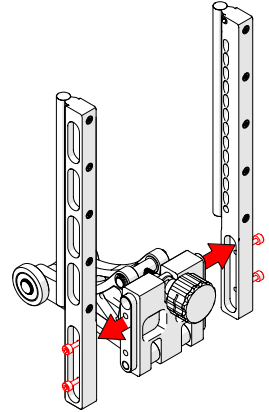

Fig. 12 - Remove clamp arms

1. Turn the vertical release knob and move the base downwards to the lowest position (Fig. 10).
2. Press the two spring pins located at the top of each clamp arm, then turn the vertical release knob to lower and remove the base from the main assembly (Fig. 11). *(Having an extra pair of hands may be necessary to complete this task)*
3. Unscrew the four bolts to detach the center idler section (Fig. 12).

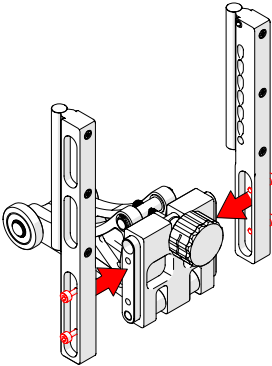

Fig. 13 - Attach clamp arms

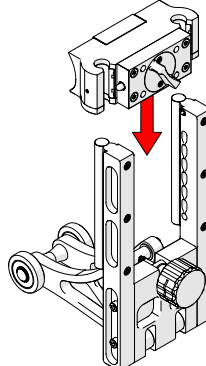

Fig. 14 - Attach base to the main assembly

4. Place the clamp arms onto the center idler section and secure them in place with the four captured screws (Fig. 13).
5. Reassemble the clamp by reversing steps 1 and 2, sliding the clamp arms up from the bottom to reinstall the base onto the main assembly (Fig. 14). It will be necessary to turn the vertical release knob to attach the base to the main assembly.