

■ MOTIX

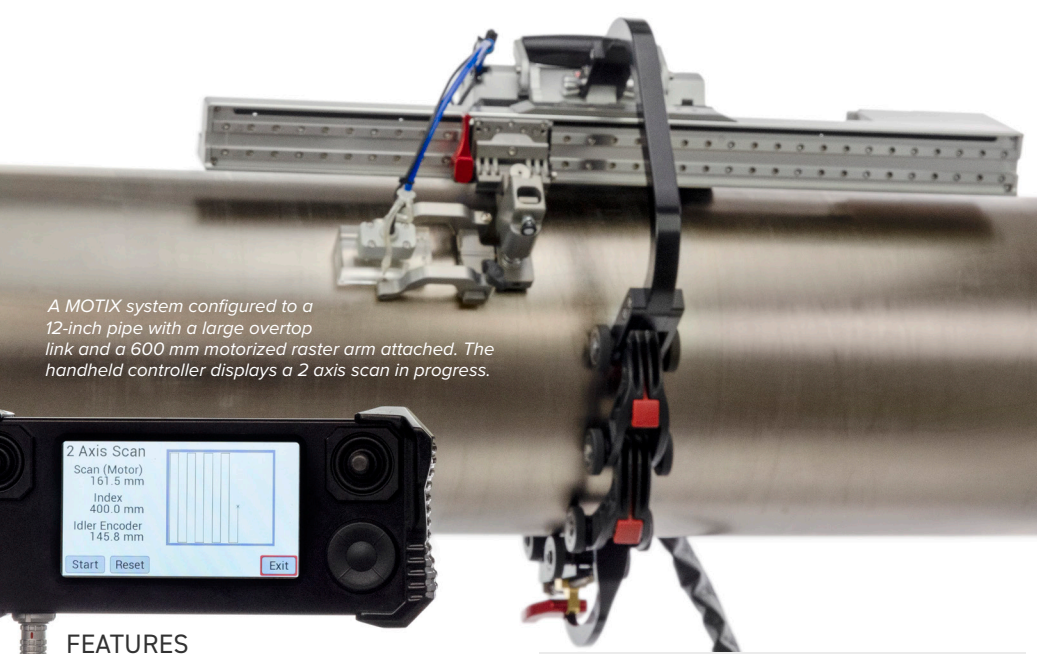

**J JIREH**





A MOTIX system configured to a 12-inch pipe with a large overtop link and a 600 mm motorized raster arm attached. The handheld controller displays a 2 axis scan in progress.

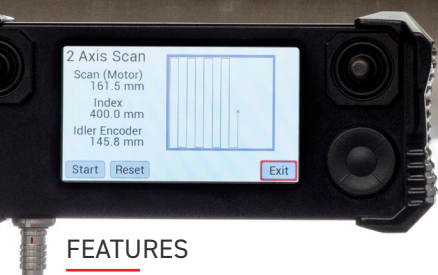

**FEATURES**

**Non-Ferrous and Ferrous Surfaces**

- An adjustable chain system mounts the MOTIX to glass fibre-reinforced plastic (GFRP or GRP), carbon fibre-reinforced plastic (CFRP or CRP), HDPE, plastic and more.

**Corrosion Inspection**

- Attach any length of motorized raster arm to the MOTIX to perform precision thickness or delamination inspection.

**Weld Inspection**

- The MOTIX can be fitted with up to four probe holders for PAUT and TOFD weld inspection.

**Remote Control**

- Manage crawler operations with the rugged handheld controller, featuring joysticks, a large colour touch screen and haptic feedback.

**Adjustability**

- The quick-release links are made from durable, fibre-reinforced plastic and can be adapted to form a chain system up to 106.7 cm (42 in) in diameter.

**Built-in Encoder**

- A spring-loaded encoder is integrated into the body of the MOTIX and provides precise positional feedback to all standard industry instruments.

**Battery Power**

- Avoid heavy, cumbersome generators. The rechargeable batteries can power the MOTIX system and accessories for hours.



Cataliver weld inspection using a standard overtop link with the chain system.

**SPECIFICATIONS**

**Circumferential Pipe Range**

- With Standard Overtop Link 15.2 cm (6 in) to 106.7 cm (42 in)
- With Large Overtop Link 20.3 cm (8 in) to 106.7 cm (42 in)

**Encoder Resolution**

- 220.4 counts/mm (5,598.4 counts/in)

**Maximum Payload**

- 9 kg (20 lb)<sup>1</sup>

**Maximum Speed**

- Variable 0 - 14.2 cm/sec (0 - 5.6 in/sec)

**Power Requirements**

- 100-240VAC, 50/60Hz, 1.4 Amps

**Maximum Umbilical Length**

- 30 m (98.4 ft)

**Inspection Surface**

- Non-Ferrous and Ferrous

**Operating Environment**

- -20° C (-4° F) to 50° C (122° F)

**Environmental Sealing**

- Dust-tight, watertight<sup>2</sup>

**Regulations<sup>3</sup>**

- CE compliance
- FCC compliance
- Industry Canada compliance
- UKCA compliance

**PARTS & ADD-ONS**

**Motorized Couplant Pump**

- A powered pumping unit to supply couplant fluid to the scanning surface.

**Heavy Duty Vertical Probe Holder**

- Compatible with the motorized raster arm, this probe holder carries large probes and the HydroFORM cart.

**TOFD Slip Joint Probe Holders**

- Enable four probe weld inspection.

**SIZE & WEIGHT**

**Crawler Weight**

- 4.6 kg (10.2 lb)

**Crawler Dimensions**

- A Height: 14.7 cm (5.8 in)
- B Width: 20.6 cm (8.1 in)
- C Depth: 26.2 cm (10.3 in)

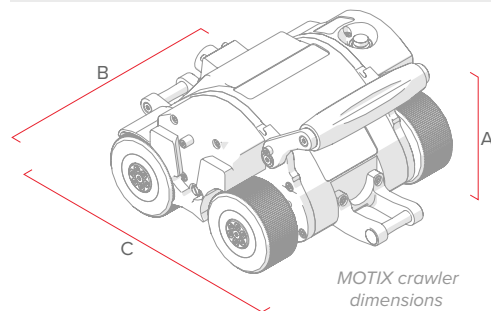

MOTIX crawler dimensions

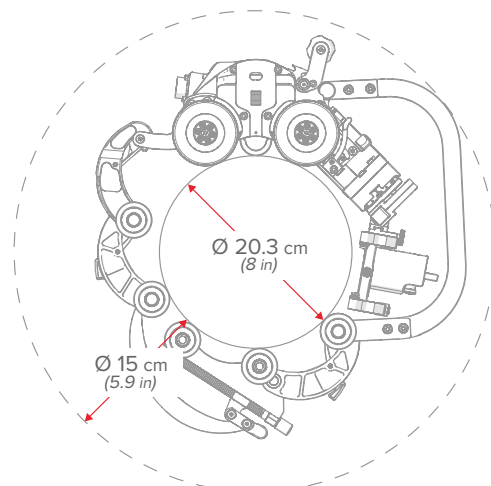

MOTIX radial clearance with large overtop link (EJS014)

1. Performance may vary with surface condition. Umbilical and attachments are considered payload.
2. Not submersible.
3. Complete regulatory certifications, please contact JIREH.
4. Technical specifications are subject to change.

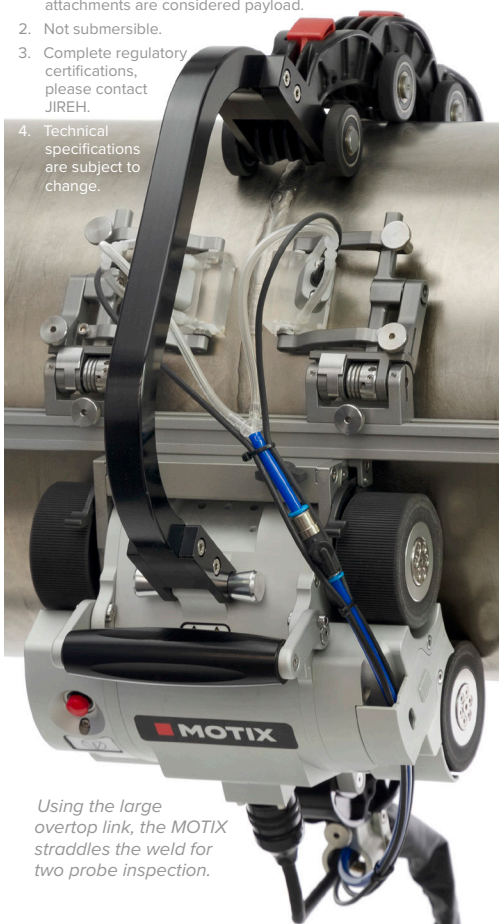

Using the large overtop link, the MOTIX straddles the weld for two probe inspection.