

■ CIRC-IT

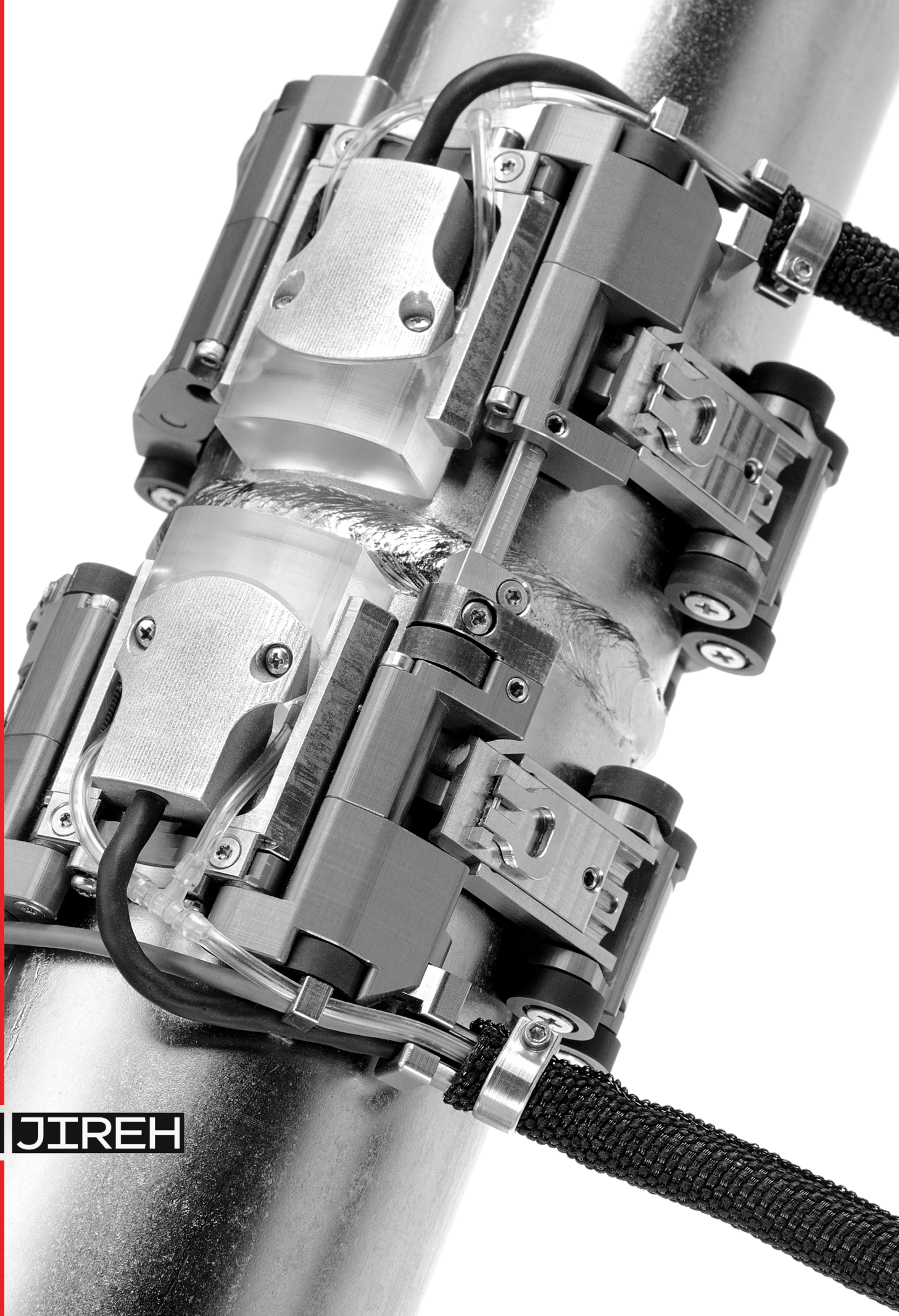

J JIREH

Two probe Circ-it configured with long, medium and short links.

Environmental Specifications

Operating Environment

- 20°C (-4°F) to 50°C (122°F)

Environmental Sealing

- Dust tight, waterproof⁴

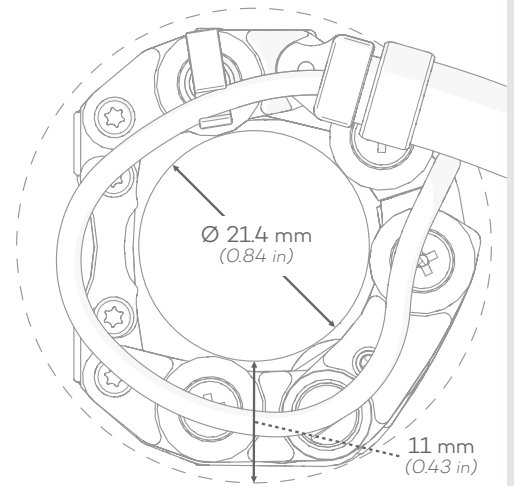

Features

Low Profile Design

- Requiring only 11 mm (0.43 in)¹ radial clearance for limited access inspection.

Small Diameter Scanning

- Scan pipe/tube sizes as small as 21.4 mm (0.84 in)².

Single or Dual Probe

- Carry two probes when required or decrease scanner width even further during single probe scans.

Adjustable Links

- Scan pipes or tubes between 21.4 - 114.3 mm (0.84 - 4.5 in) using the easy-to-use snap-together link system.

Urethane Wheels

- Durable urethane wheels provide smooth motion and traction during vertical scan applications.

Weight and Dimensions

Scanner Weight

- Single Probe 85 g (3 oz)
- Dual Probe 166 g (5.86 oz)

Scanner Dimensions (Dual Probe)

- A Height 11 mm (0.43 in)²
- B Width 114.6 mm (4.5 in)
- C Length 107.7 mm (4.2 in)⁵

Probe Compatibility

- Olympus A15 small-footprint probes and wedges.

- Scanner only, Transducers and wedges not included.
- Removal of the encoder cable guard is required for scan diameters smaller than 31.75 mm (1.25 in).
- Custom encoder cable lengths are available.
- Not submersible.
- Does not include cable management (sleeving).
- This maximum probe spacing is achieved using the included 94 mm (3.7 in) crossbars.

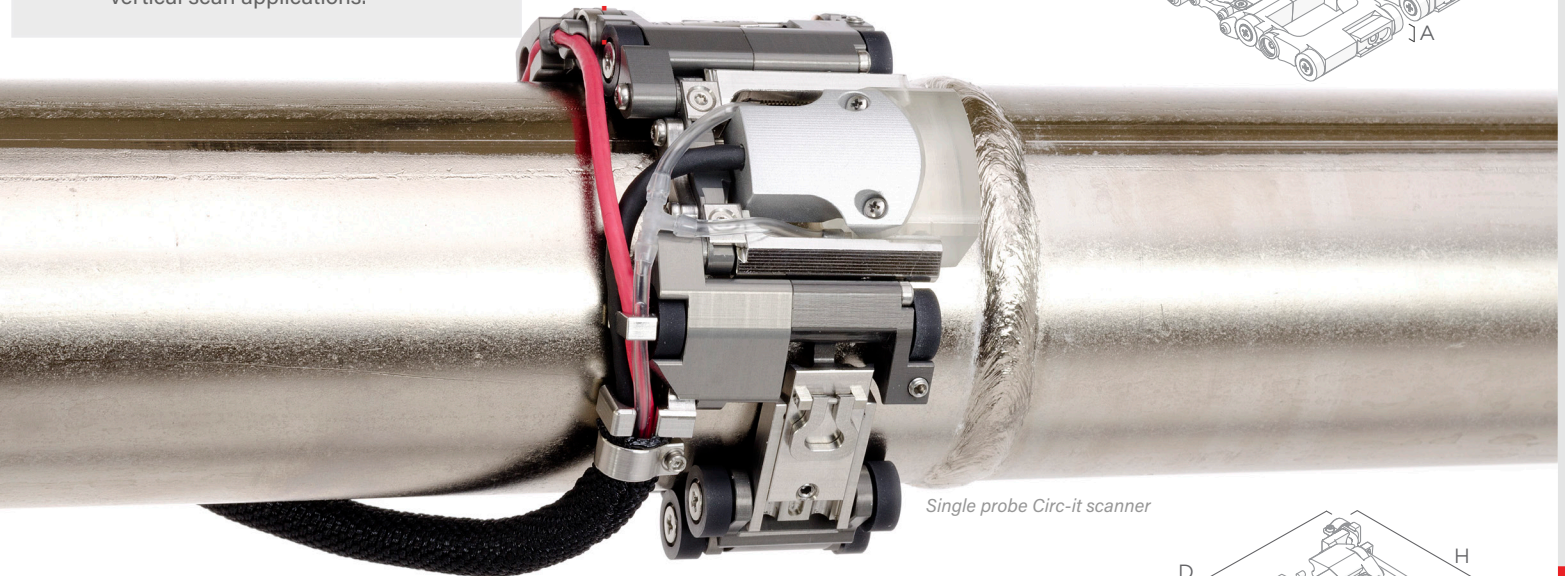
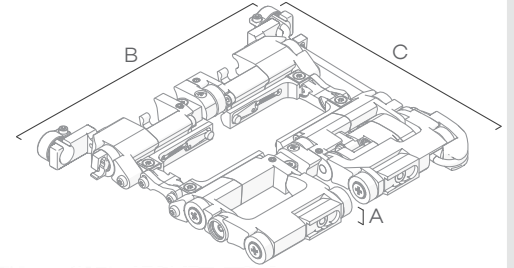

Single probe Circ-it scanner

- D Width (Max) 184.6 mm (7.3 in)
- E Probe Spacing 70 mm (2.8 in)⁶

Scanner Dimensions (Single Probe)

- F Height 11 mm (0.43 in)²
- G Width 53.5 mm (2.1 in)
- H Length 107.7 mm (4.2 in)

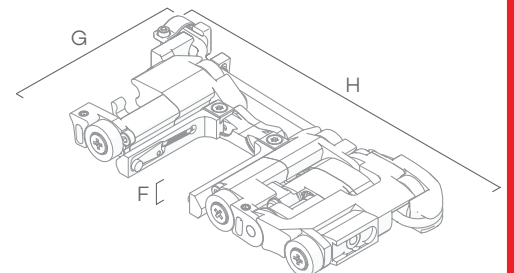
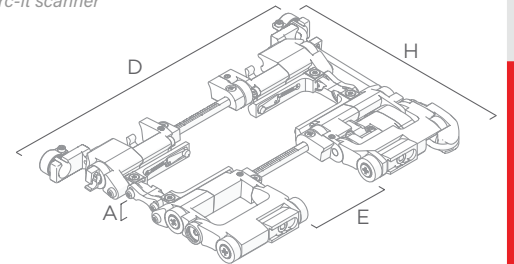

Specifications

Pipe Diameter Range²

- 21.4 - 114.3 mm (0.84 - 4.5 in)

Minimum Radial Clearance

- 11 mm (0.433 in)¹

Encoder Resolution

- 31.3 counts/mm (795.0 counts/inch)

Encoder Cable Length

- 3 m (9.8 ft)³

Inspection Surface

- Ferrous and non-ferrous

Accessories

Manual Couplant Pump

- 1 litre (0.26 U.S. gal) couplant pump

Circ-it Spare Parts Kit

- A valuable addition of parts to compliment a Circ-it system.